

LONGITUDINAL JOINTS IN DECK SLAB
(ONE-COURSE CONSTRUCTION)

ISSUED: 2009

PLATE
3.8-1

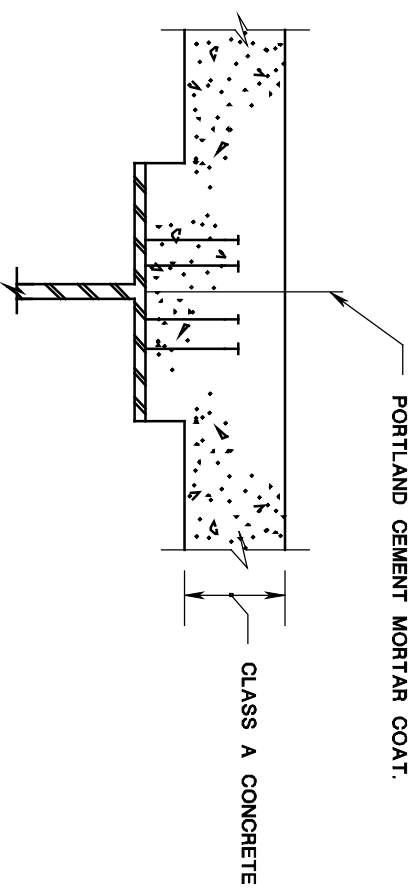

DETAIL No. 1
LONGITUDINAL CONSTRUCTION
JOINT IN DECK SLAB

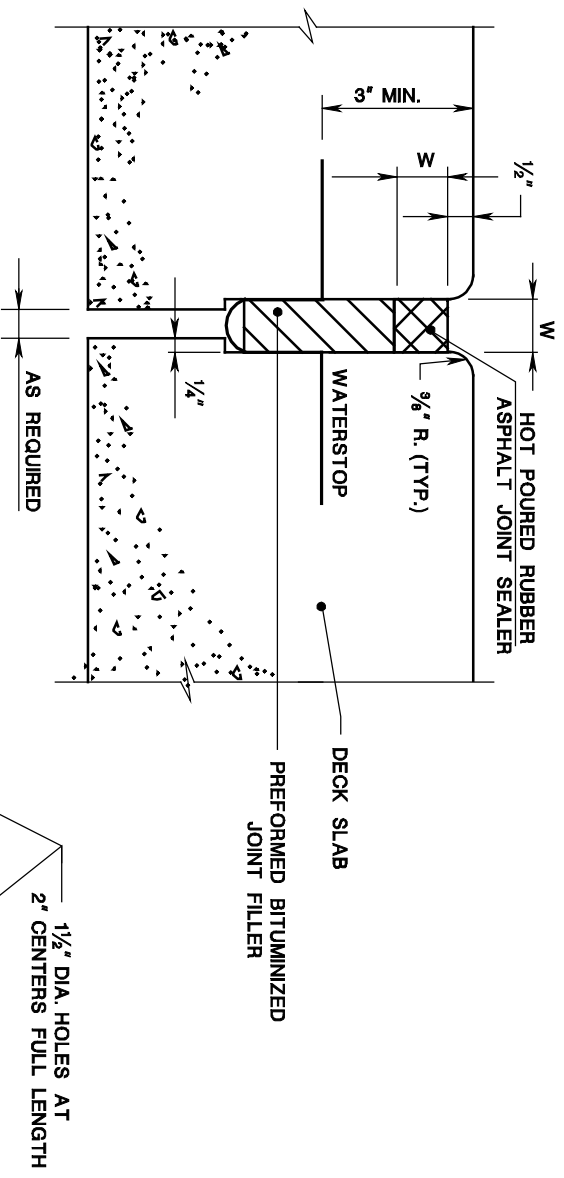

DETAIL No. 2
LONGITUDINAL EXPANSION
JOINT IN DECK SLAB

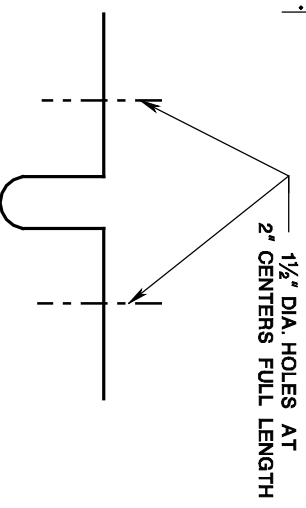

COPPER WATERSTOP DETAIL

NOTE TO DESIGNER:

- (1) SEE SUBSECTION 21.3 OF THIS MANUAL FOR FURTHER INFORMATION.
- (2) SEE PLATE 3.8-2 WHEN LONGITUDINAL JOINTS USE PREFORMED ELASTOMERIC SEAL DETAILS.